

SPT004 FSU 600 - ASSEMBLY INSTRUCTIONS



Unit 1-4
Old Mill Park
15 Sucrose Crescent
Mount Edgecombe
4302
T_27-87-3514800 / F_27-31-5024001
Hewitt and Associates®
www.hewittpop.com

dream · design · deliver

Contents

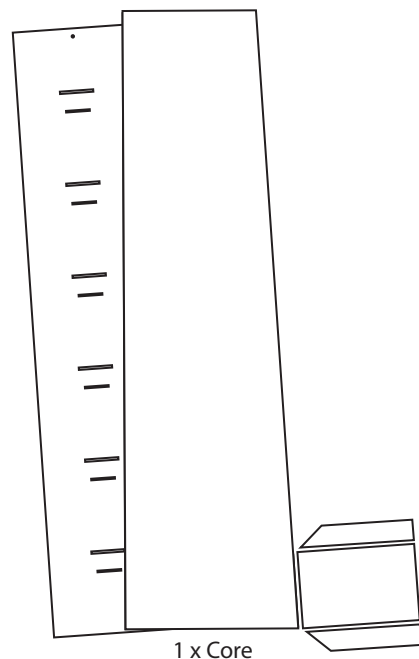

1 x Core

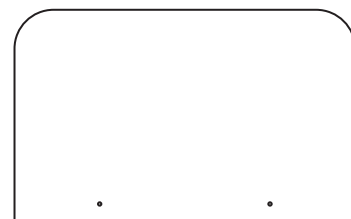

1 x Header



6 x Shelves



2 x Plastic Pins

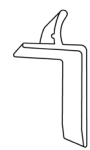

12 x Plastic Clips

NB: Before assembly, pre-crease, fold all elements across crease lines & remove all excess material.
NEVER ATTEMPT TO MOVE A STOCKED UNIT.

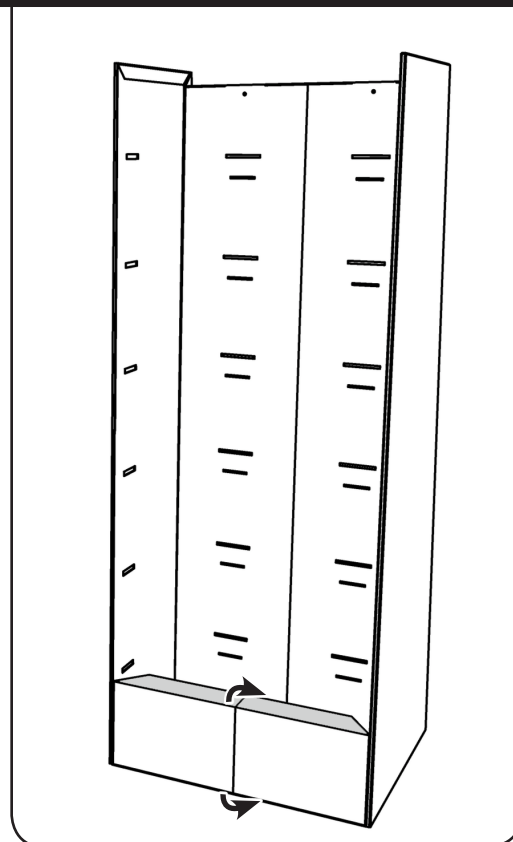

1 Expand core unit and stand upright. Fold base flaps on top and bottom to secure unit.

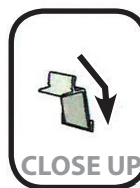
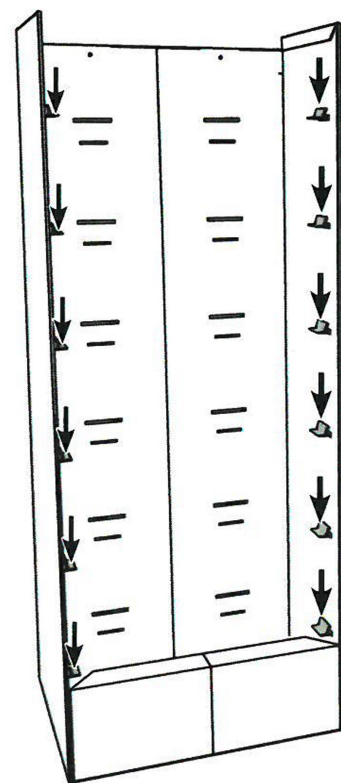

2 Insert plastic clips to the unit. Push down to secure.

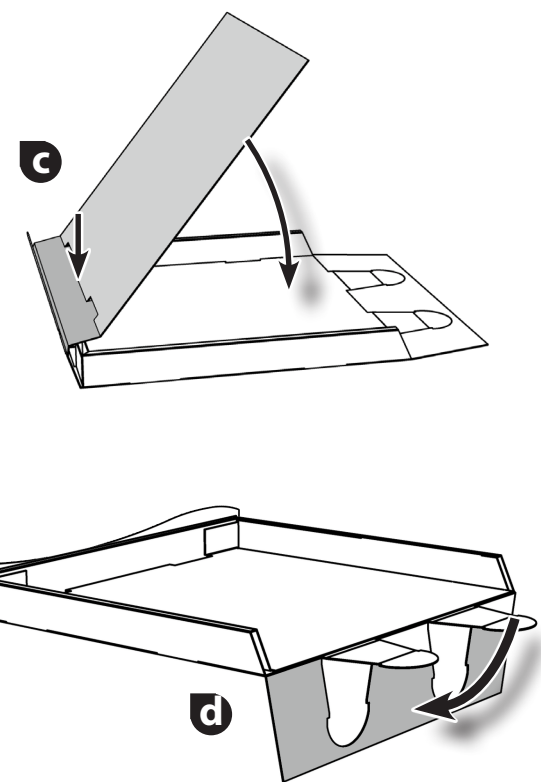
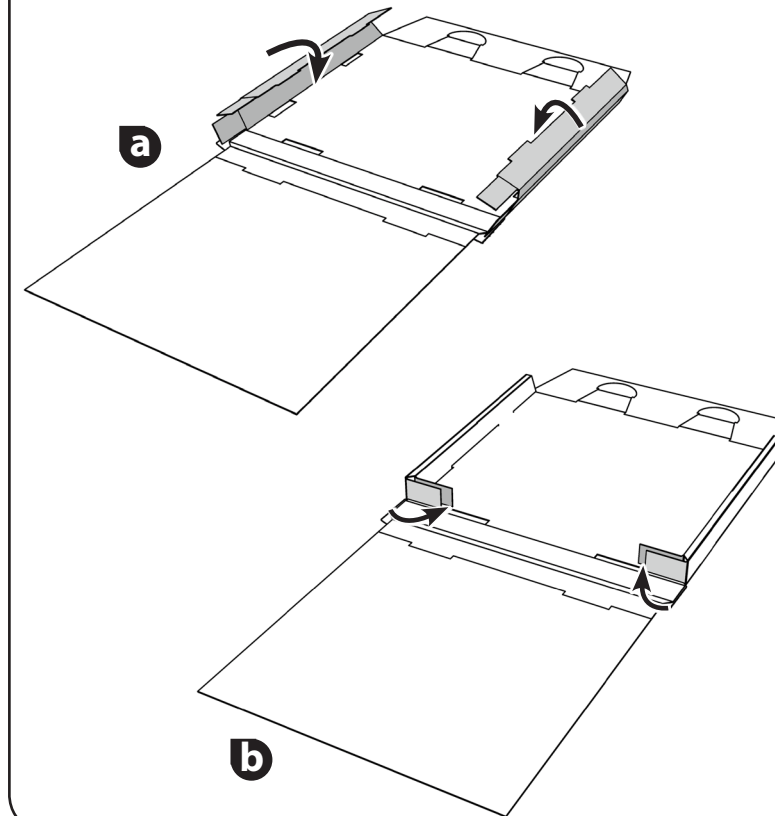

3 a) - d) Make up shelves as shown ensuring the tabs are pushed firmly into their slots to secure shelves from opening.

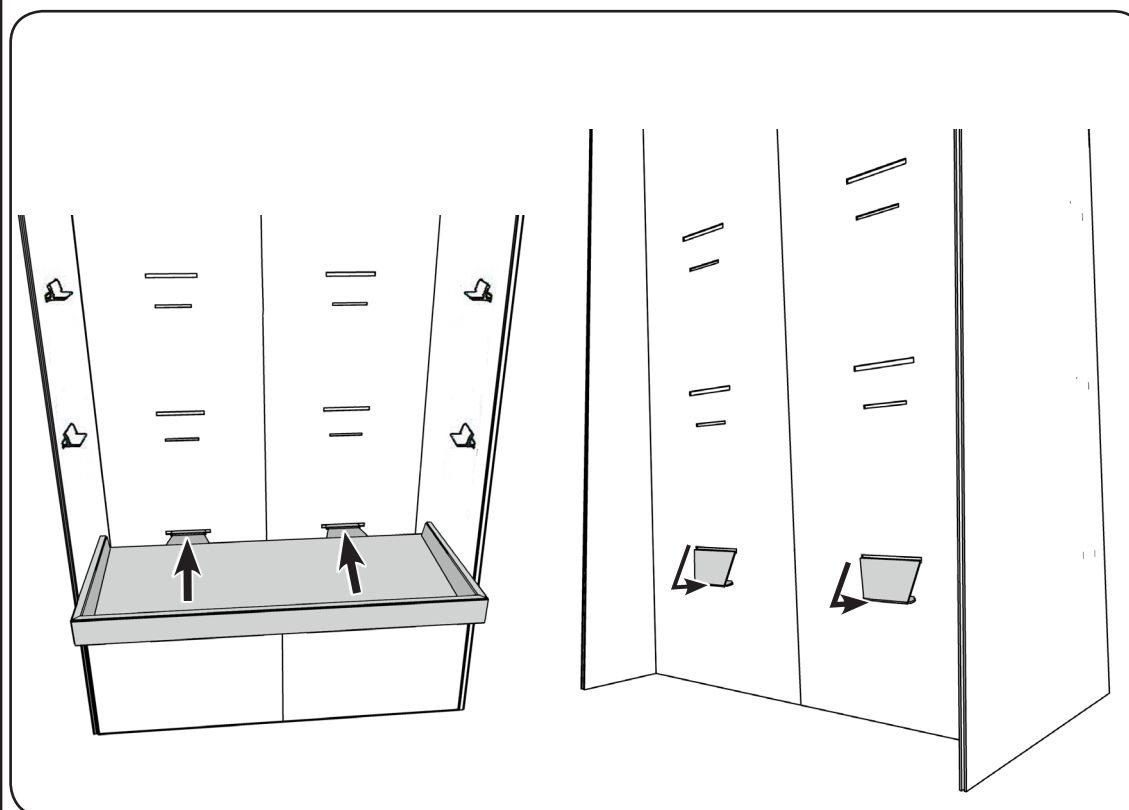

4 Insert the shelves as shown above making sure the end tabs pass through the slots provided. Lock the shelves into place by pushing the end part of the tabs through the bottom slots provided. Push the shelves down onto plastic clips until you feel a click to secure shelves.

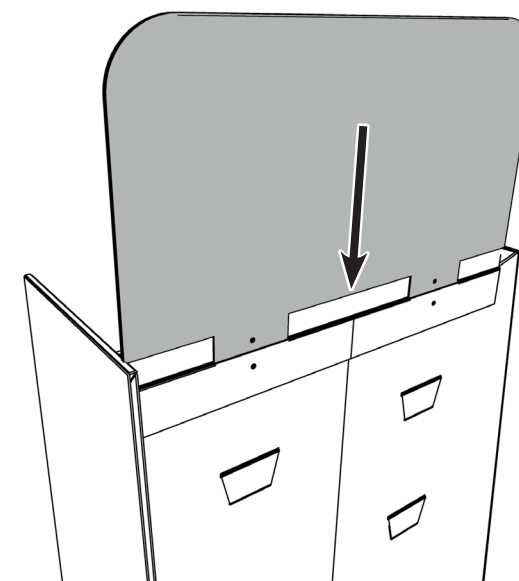

5 Insert the header into the slots at the back of the unit and pin from the front.

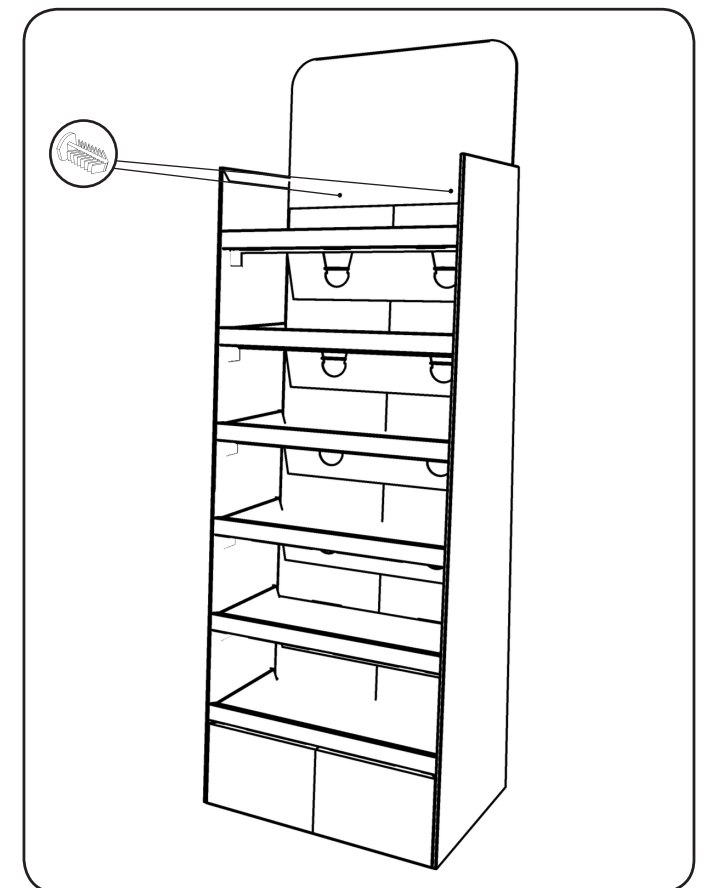

6 The unit is now complete.